

Lehigh Valley
International Airport

Allentown, PA
The Sheward Partnership

3,650 sf glass
Aviation

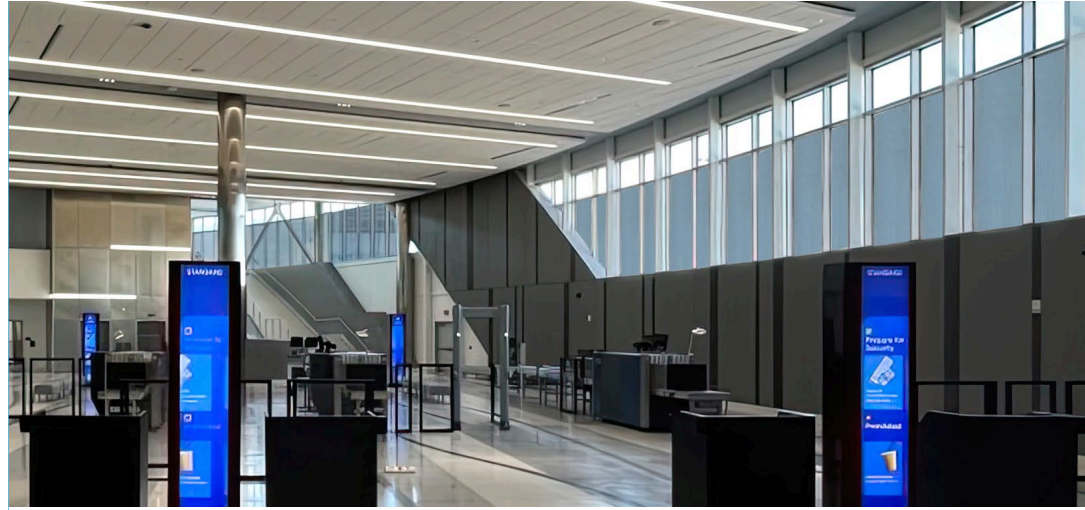

HALIO's electrochromic window technology will automatically darken the windows on hot, sunny days, and let in more light on cold winter days. The technology will help the airport use less energy for air conditioning and heating and should provide about 27% in energy savings per year.

Thomas Stoudt
Executive Director, Lehigh-North Hampton Airport Authority

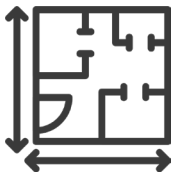

The
Challenge

- Create a public space with natural light that remains comfortable year-round.
- Reduce energy load to cool the space in warm seasons and harvest daylight in cold seasons.
- Utilize building materials and designs that can contribute to environmental leadership.



Our
Solution

- Install smart glass facades in the terminal connector corridor and TSA screening area.
- Include narrow upper lites that can independently tint to allow reflective ceiling lighting without glare.
- Optimize tint levels to seasonally to reduce HVAC load year-round.



The
Benefits

- Temperature is controlled with less HVAC, saving up to 27% on energy.
- Energy savings/carbon reduction helped the facility achieve Leadership in Energy and Environmental Design Gold certification.
- Blinds and building solar shades were not required, lowering construction costs and maintenance OpEx.